

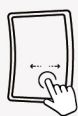

Key features



Edge to Edge Multi-Touch PCAP

Seamlessly interact with ultra-responsive edge-to-edge capacitive touch technology, delivering precise input. Perfect for commercial, industrial, and educational applications.



LED Surround

Enhance visibility and system with customizable LED lighting, ideal for capturing attention in retail, gaming, or interactive kiosks. The LED surround ensures vibrant illumination in any environment.



Extruded Aluminum Frame

Engineered for durability and aesthetics, the lightweight extruded aluminum frame provides robust protection, ensuring the monitor withstands demanding environments without compromising design.



Chemically Strengthened Glass

Experience superior onage with high-strength, chemically reinforced glass. Built to resist scratches and impacts, this 3mm glass ensures longevity in high-traffic and industrial settings.



USB and Serial Touch

Enjoy versatile connectivity with USB and serial touch interfaces, making integration with modern and legacy systems effortless. Ideal for seamless compatibility across diverse applications.



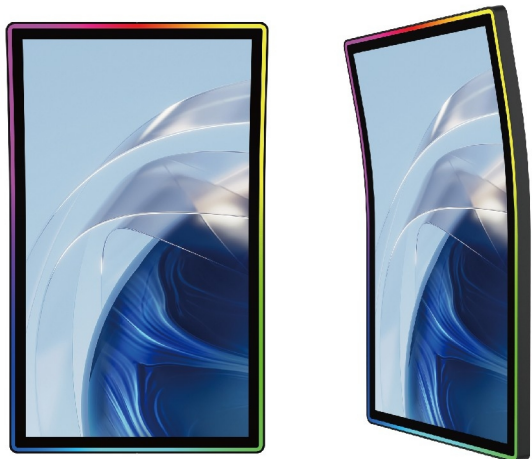

43" J-Curve

Display Ratio	16:9
Backlight	IPS
MTBF	50000Hrs
Active Area	941.18mm × 529.42mm
Viewing Angle	89°/89° (Left / Right), 89°/89° (Vertical/Horizontal)
Support Color	16.7 Million Colors
Response Time	Typ . 5ms
White Luminance	Typ. 300cd/m2
Contrast Ratio	Typ . 3000:1
Display Resolution	4K [UHD]



43" C-Curve

Display Ratio	16:9
Backlight	IPS
MTBF	50000Hrs
Active Area	924.40mm × 529.40mm
Viewing Angle	89°/89° (Left / Right), 89°/89° (Vertical/Horizontal)
Support Color	16.7 Million Colors
Response Time	Typ . 8ms
White Luminance	Typ. 300cd/m2
Contrast Ratio	Typ . 3000:1
Display Resolution	4K [UHD]



43" Vertical

Display Ratio	16:9
Backlight	IPS
MTBF	50000Hrs
Active Area	940.90mm × 529.25mm
Viewing Angle	89°/89° (Left / Right), 89°/89° (Vertical/Horizontal)
Support Color	16.7 Million Colors
Response Time	Typ . 8ms
White Luminance	Typ. 400cd/m2
Contrast Ratio	Typ . 1200:1
Display Resolution	4K [UHD]



32" C-Curve

Display Ratio	16:9
Backlight	LED
MTBF	50000Hrs
Active Area	698.40mm × 392.85mm
Viewing Angle	89°/89° (Left / Right), 89°/89° (Vertical/Horizontal)
Support Color	16.7 Million Colors
Response Time	Typ . 8ms
White Luminance	Typ. 400cd/m2
Contrast Ratio	Typ . 1200:1
Display Resolution	1920 × 1080 [FHD]